

EvoTouch.204 DALI-2 Glass Touch Panel, 2 Buttons, 1 Slider

TCH-204x-001 is a modern DALI-2 control panel that combines advanced technology with sophisticated design. Its glass front and intuitively designed icons provide an elegant and universal interface that meets the expectations of even the most demanding users. The panel, equipped with two touch buttons and a slider, enables precise switching on, switching off, as well as smooth dimming of the light level. It is ideal for controlling two scenes or groups of DALI luminaires. Additionally, two LED indicators signal the control status of individual groups or the selected scene, significantly enhancing user comfort. Available in classic white or elegant black. Custom versions, including panel colours, slider and icons configuration, are available on individual request.

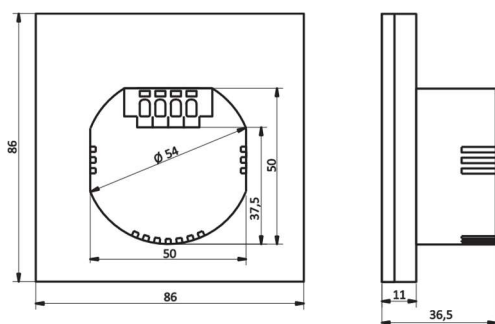
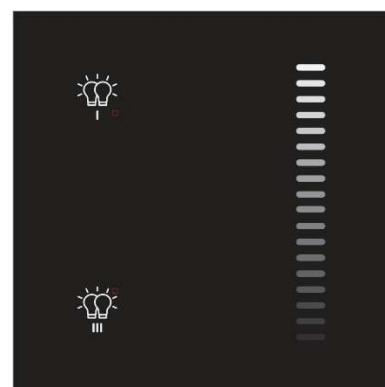
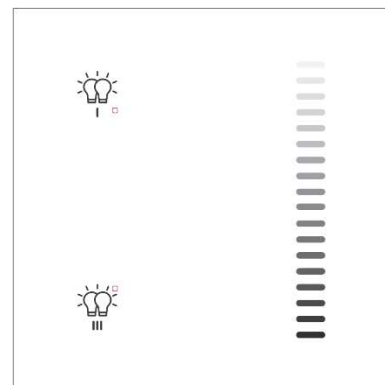

Technical specifications

Power supply	9,5 ÷ 22,5 V DC (via DALI Bus)
Current consumption from DALI Bus	3 mA
Communication protocol	DALI-2
Number of DALI addresses	1
Number of status indicator LEDs	2 x LED, configurable
Wiring terminals	WAGO spring terminals, wire from 0,25 to 2,5 mm ²
Mounting	Ø60 mm flush-mount box
Dimensions	86 x 86 x 36,5 [mm]
Color	White or black
Materials	ABS + PC + Glass
Operating temperature	0 °C to +50 °C
Storage temperature	-20 °C to +50 °C
Relative humidity	5 % ÷ 90 %, non-condensing
Weight	140 g
Protection	IP 20
Conformity mark	CE
Part number / EAN – White colour	TCH-204W-001 / 5904423369063
Part number / EAN – Black colour	TCH-204B-001 / 5904423369070